

**RBC1 Round Belt Curve**  
**Instruction & Maintenance Manual**  
**RBC1 圆带弯道安装使用维护手册**

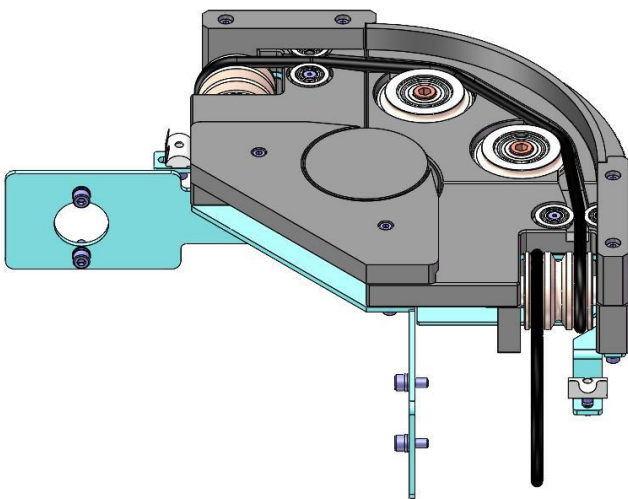

RBC1/0-90

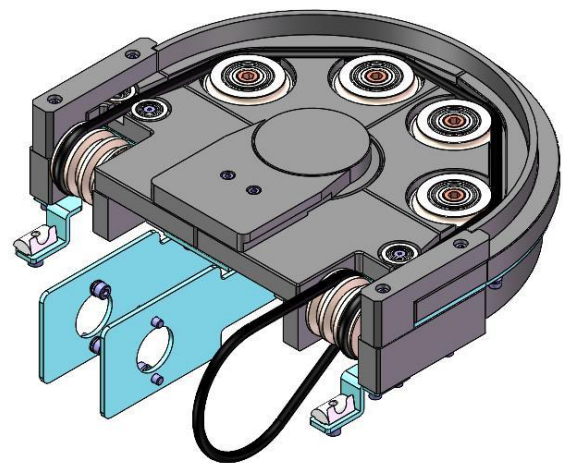

RBC1/0-180

Suzhou LinkedGo Transfer System Co.,Ltd.

苏州领科工业技术有限公司

## Structure Diagram 结构示意图

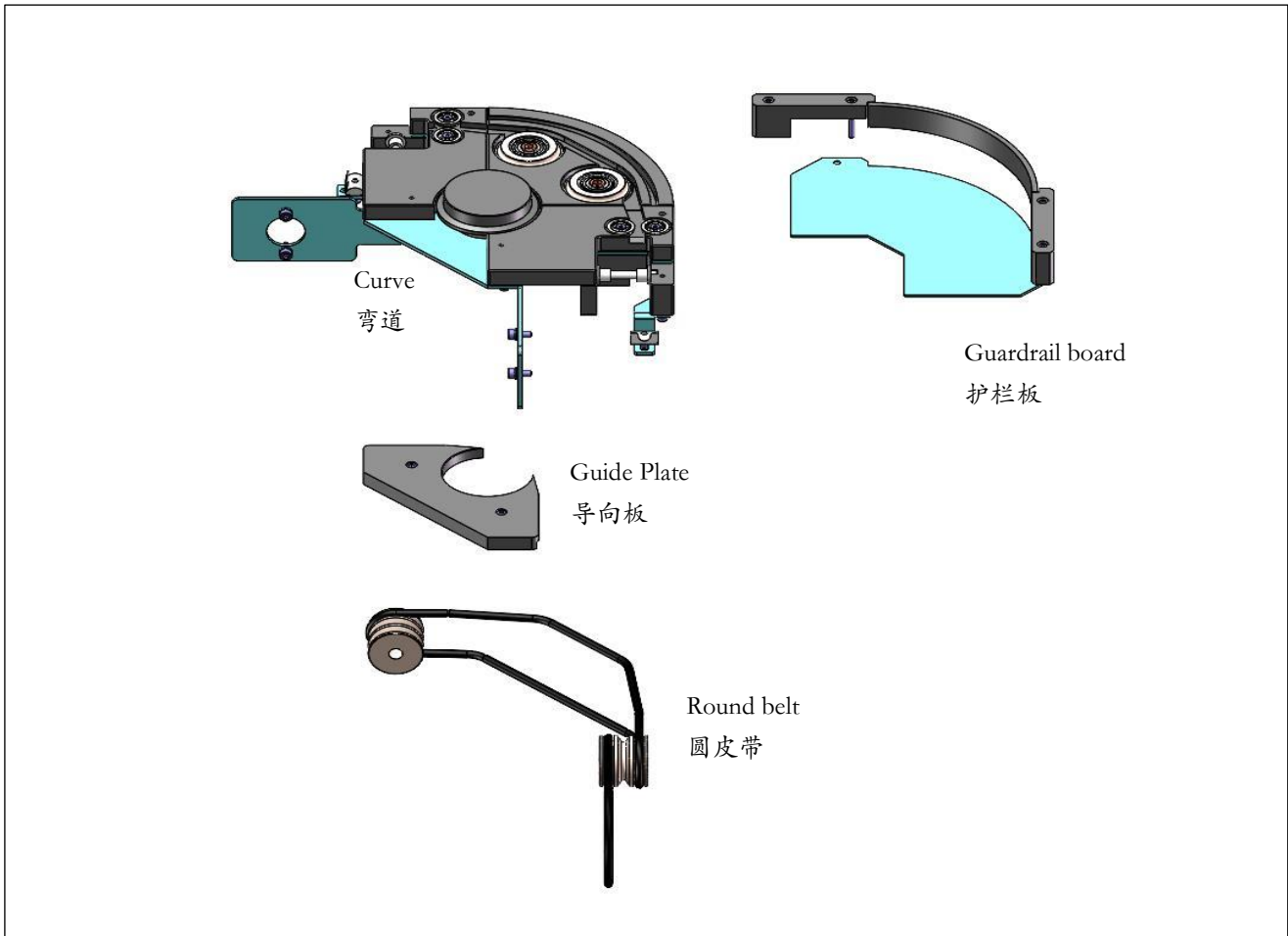

产品特征

安装步骤

维护保养

1. The RBC1/0-90 type with circular bends is used for transporting workpiece pallets in  $90^\circ$  bends, while the RBC1/0-180 type is used for transporting workpiece pallets in  $180^\circ$  bends. Both types do not allow pallets to stack and only allow a single pallet to pass through at a time.

1、圆带弯道 RBC1/0-90 型用于  $90^\circ$  弯道运输工件托盘，RBC1/0-180 型用于  $180^\circ$  弯道运输工件托盘，两种类型皆不允许托盘堆积，一次只允许单个托盘通过。

2. The conveying medium is a circular belt.

2、输送介质为圆皮带。

3. It can be divided into two types of curved conveying:  $90^\circ$  and  $180^\circ$ .

3、可分为  $90^\circ$  和  $180^\circ$  两种弯道输送。

4. The total weight of the workpiece tray can reach up to 3kg.

4、工件托盘总重量最多达 3kg。

5. Cannot perform reverse operation

5、不可进行反向运行。

## Model Description 型号说明

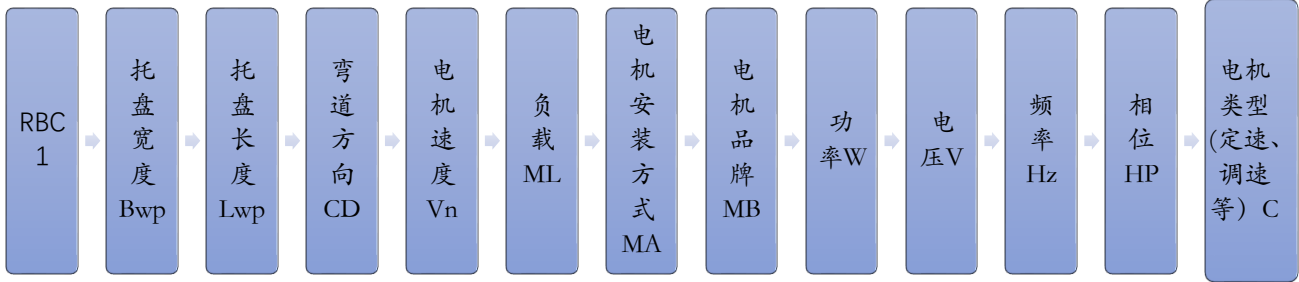

例: RBC1-Bwp80-Lwp80 -CDR-Vn12-ML30-MAL011A - MBNORD-120W-380V-50Hz-3HP-C0

## 参数说明 Parameter Description

The model RBC1-Bwp80-Lwp80 -CDR-Vn12-ML30-MAL011A - MBNORD-120W-380V-50Hz 3HP-C0 represents a fixed speed motor with a tray width of 160mm, tray length of 160mm, right bend direction, running speed of 12m/min, running load of 30kg, motor installation position L011A, motor brand NORD, power of 120W, voltage of 380V, frequency of 50Hz, and phase of 3.

型号 RBC1-Bwp80-Lwp80 -CDR-Vn12-ML30-MAL011A - MBNORD-120W-380V-50Hz-3HP-C0, 表示托盘宽度 80mm, 托盘长度 80mm, 弯道方向为右, 运行速度 12m/min, 运行负载 30kg, 电机安装位置为 L011A, 电机品牌为 NORD, 功率为 120W, 电压为 380V, 频率为 50Hz, 相位为 3。

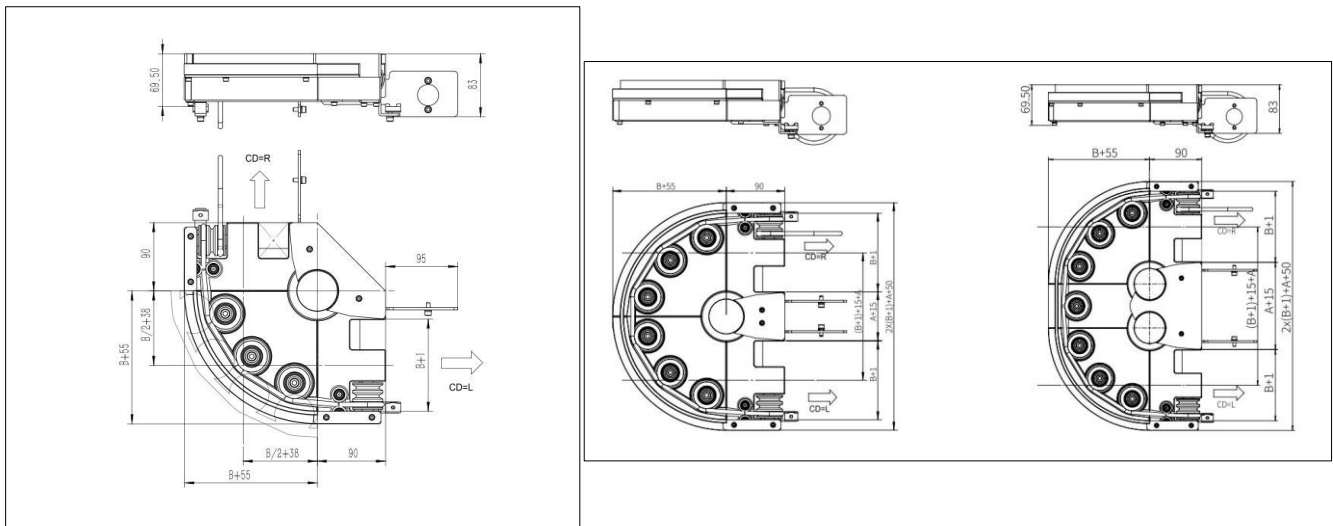

产品特征

安装步骤

维护保养

## 安装步骤 Installation steps

A Assemble the circular belt bending frame, taking RBC1-90 as an example in the following figure, and operate RBC1-180 in the same way.

A 组装圆带弯道框架，下图以 RBC1-90 为例，RBC1-180 同样操作。

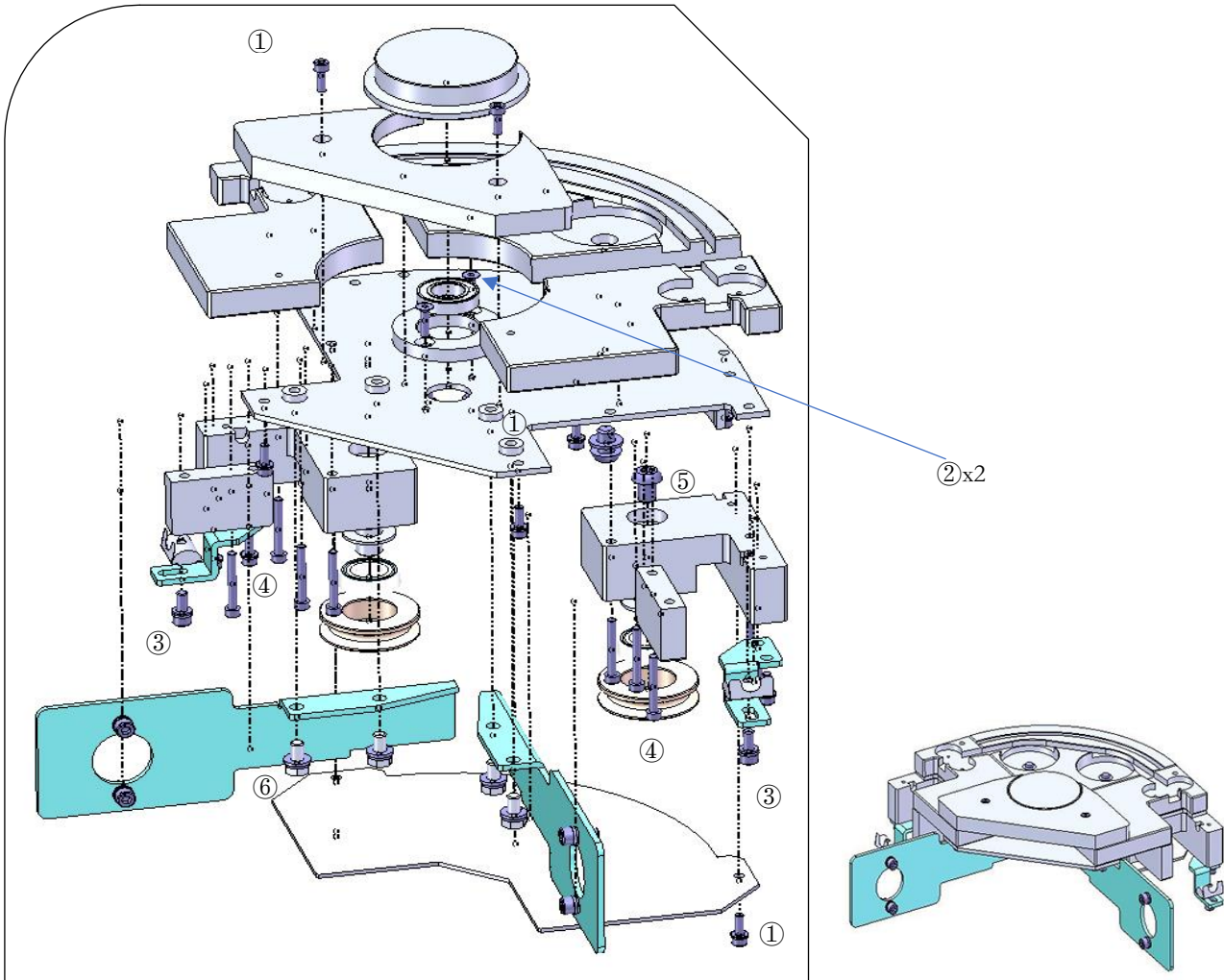

① — M4x12  
4 5Nm

② — M4x16  
4 5Nm

③ — M5x12  
5 5Nm

④ — M4x30  
4 5Nm

⑤ — M8x32  
8 13Nm

⑥ — M6x12  
Sw13 13Nm

产品特征

安装步骤

维护保养

B Install the pulley and circular belt. Taking RBC1-90 as an example in the following figure, RBC1-180 operates similarly.

B 安装带轮、圆皮带，下图以 RBC1-90 为例，RBC1-180 同样操作。

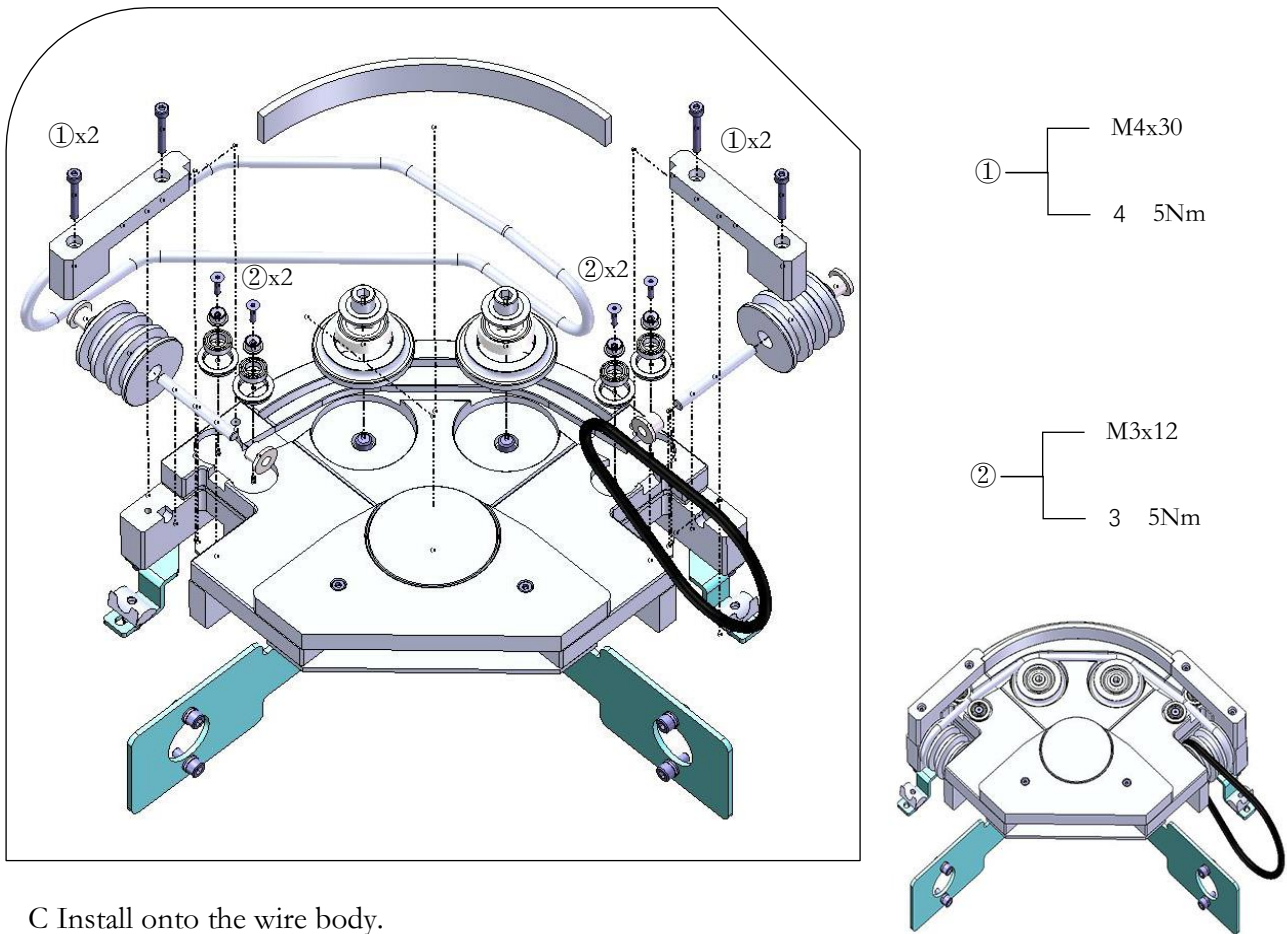

C Install onto the wire body.

C 安装到线体上。

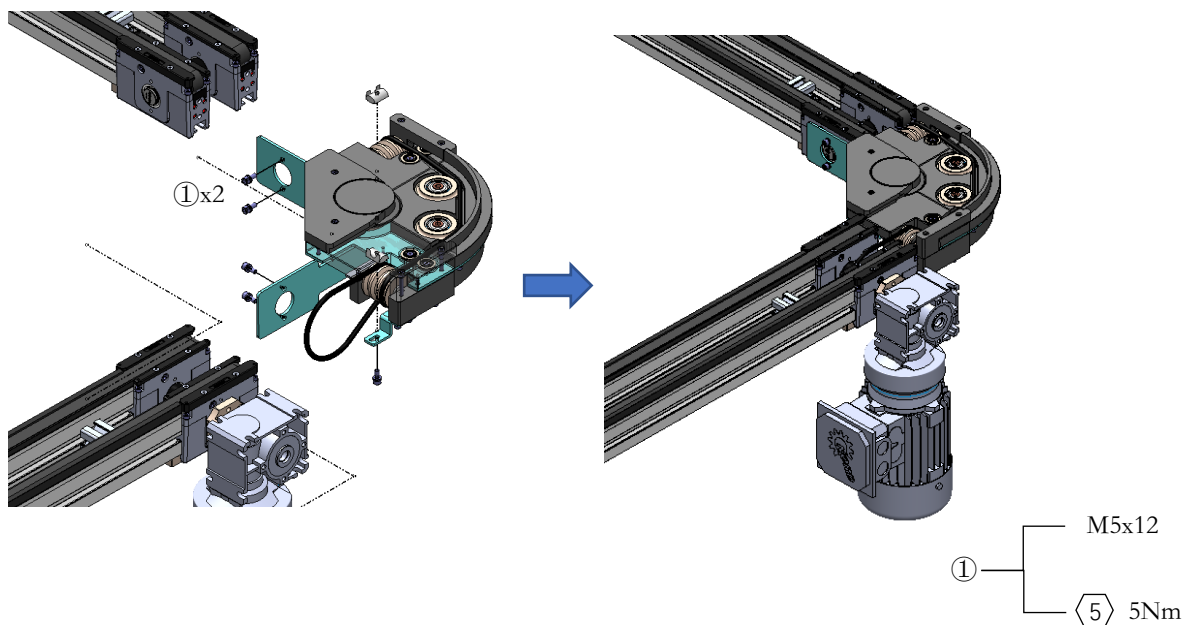

产品特征

安装步骤

维护保养

## Maintenance 维护和保养

The UTS series tray conveying system requires regular maintenance and upkeep to extend the service life of the line. The conveying equipment should be kept clean to avoid direct sunlight or rain or snow, and to prevent contact with substances such as acids, alkalis, oils, organic solvents, etc.

UTS 系列托盘输送系统需按周期进行规定的保养维护工作，以延长线体使用寿命。输送设备应保持清洁避免阳光直射或雨雪浸淋，防止与酸、碱、油类、有机溶剂等物质接触。维护前需关闭对应的能源供给。

### Daily Maintenance

#### 日维护

Regularly clean the conveyor line. Before starting the machine every day, it is necessary to clean the floating dust, falling small parts, and other obstacles on the chain and wire body to prevent dust and dirt from affecting the operation of the wire body. When cleaning the machine head, it is necessary to remove the upper cover of the machine head and use an air gun to remove any accumulated dust inside. During trial operation, check all parts of the conveyor line for abnormalities, such as loose bearings or abnormal noise. Once any abnormalities are found, repair and replace them immediately. The steel wheel chain needs to be lubricated daily. 定期清洁输送线。每日开机前需清理链条及线体上的浮尘、掉落的小零件及其他障碍物，防止积尘和污垢影响线体运行。在清洁机头时，需拆掉机头上盖，用气枪清除里面积压的灰尘。试运行前，检查输送线的各部位是否有异常，如轴承有无松动或异常噪音，一旦发现异常应即使维修和更换。钢制轮链条需每日润滑。

### Weekly Maintenance

#### 周维护

Regularly inspect the accessories on the conveyor line body. For easily damaged parts such as sprockets, bearings, and idlers, regular inspection, maintenance, and lubrication are required. If damage or looseness is found, it must be replaced immediately. Check if the fasteners on the wire body are loose and tighten them in a timely manner.

定期检查输送线体上的附件。对于链轮、轴承、惰轮等容易损坏的零件，需定期检查、保养和润滑。发现损坏和松动须立即更换。检查线体上的紧固件是否有松动情况，及时紧固。

### Quarterly maintenance

#### 季度维护

Check if the guide strip and friction strip are severely worn or deformed, and replace them in a timely manner. Confirm that the running condition is good, observe if the chain is loose, and if there is any looseness, shorten the chain length by removing the chain link.

检查导向条、磨擦条是否磨损严重或者变形，并及时更换。确定运行状况良好，观察链条是否松弛，如有松动，可通过去除链节的方式缩短链条长度。

#### Disclaimer

#### 免责声明

The customer shall inspect the equipment regularly. If the customer fails to maintain the conveyor as the state above, leading to any malfunction or damage to the conveyor, our company will not be responsible for it, all related costs (including material costs, installation and commissioning fees, and hotel expense) shall be borne by the customer.

客户应定期对设备进行检查。若客户未按要求对输送机进行维护，进而导致输送机发生任何故障或损坏，我司将不承担相关责任，由此产生的相关费用（材料费，安装调试费，差旅费）均由客户承担。

Suzhou LinkedGo Transfer System Co.,Ltd.  
苏州领科工业技术有限公司

[Tel: +86-512-6636 1885](tel:+86-512-66361885)

Add: Room 706, Building D, Dongchuang Science and Technology Park,  
No. 216 Jinfeng Road, Wuzhong District, Suzhou, P.R. China

Zip code:215101

E-mail: [Sales@LinkedGo.com.cn](mailto:Sales@LinkedGo.com.cn)

Website: [www. LinkedGo.com.cn](http://www.LinkedList.com.cn)

Subject to technical modifications

电话: +86-512-6636 1885

地址: 苏州市吴中区木渎镇金枫路 216 号东创科技园 D 幢 706 室

邮编: 215101

邮箱: [Sales@LinkedGo.com.cn](mailto:Sales@LinkedGo.com.cn)

网址: [www.LinkedList.com.cn](http://www.LinkedList.com.cn)

我司保留技术更改的权利